

## KCS Tubular terminal

for multi-wire Cu cables

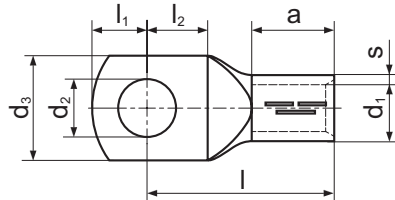

Material: galvanically tinned copper  
Non tinned on request.

| Cross section [mm <sup>2</sup> ] | For screw M | d <sub>2</sub> [mm] | Symbol     | s [mm] | d <sub>1</sub> [mm] | d <sub>3</sub> [mm] | a [mm] | l <sub>1</sub> [mm] | l <sub>2</sub> [mm] | l [mm] | Weight [g/pce] | Unit [pcs] | Dies discriminant | Crimping tools   |
|----------------------------------|-------------|---------------------|------------|--------|---------------------|---------------------|--------|---------------------|---------------------|--------|----------------|------------|-------------------|--|
| 2,5                              | 4           | 4,3                 | KCS 4-2,5  | 0,95   | 2,3                 | 7,5                 | 7      | 5                   | 6                   | 17     | 1,66           | 100        |                   |  |
|                                  | 5           | 5,3                 | KCS 5-2,5  |        |                     | 8,5                 | 7      | 5,5                 | 6,2                 | 17     | 1,70           |            |                   |  |
|                                  | 6           | 6,4                 | KCS 6-2,5  |        |                     | 9,5                 | 7      | 6,7                 | 7,3                 | 18     | 1,82           |            |                   |  |
|                                  | 8           | 8,4                 | KCS 8-2,5  |        |                     | 13                  | 7      | 7,3                 | 10                  | 22     | 2,05           |            |                   |  |
| 4                                | 4           | 4,3                 | KCS 4-4    | 1      | 3                   | 8,5                 | 8      | 5                   | 6                   | 19     | 2,30           | 50         |                   | PR33,<br>PP19  |
|                                  | 5           | 5,3                 | KCS 5-4    |        |                     | 9                   | 8      | 5,5                 | 6,2                 | 19     | 2,30           |            |                   |  |
|                                  | 6           | 6,4                 | KCS 6-4    |        |                     | 10                  | 8      | 6,5                 | 7,3                 | 20     | 2,44           |            |                   |  |
|                                  | 8           | 8,4                 | KCS 8-4    |        |                     | 13                  | 8      | 9,5                 | 10                  | 23     | 2,90           |            |                   |  |
| 6                                | 4           | 4,3                 | KCS 4-6    | 1      | 4                   | 9,5                 | 9      | 5                   | 6                   | 20     | 3,26           | 50         | 6                 | EPZC300, EPZ300,<br>GZ300, HRZ300,<br>PRZ240, PR33,<br>GO300, HR300,<br>GU300, GU120,<br>HR100-U, PR240,<br>PR50, PP19, A11/6                  |
|                                  | 5           | 5,3                 | KCS 5-6    |        |                     | 9,5                 | 9      | 6                   | 6,2                 | 20     | 3,32           |            |                   |  |
|                                  | 6           | 6,4                 | KCS 6-6*   |        |                     | 11                  | 9      | 6                   | 7,5                 | 21,5   | 3,48           |            |                   |  |
|                                  | 8           | 8,4                 | KCS 8-6    |        |                     | 13                  | 9      | 9,5                 | 10                  | 24     | 4,10           |            |                   |  |
| 10                               | 5           | 5,3                 | KCS 5-10   | 1,2    | 4,5                 | 12                  | 10     | 7,5                 | 8                   | 23     | 5,32           | 50         | 7                 | EPZC300, EPZ300,<br>GZ300, HRZ300,<br>PRZ240, GO300,<br>HR300, GU300,<br>GU120, HR100-U,<br>PR240, PR50,<br>R50, PP19                          |
|                                  | 6           | 6,4                 | KCS 6-10*  |        |                     | 12                  | 9      | 6                   | 7,5                 | 22,5   | 5,54           |            |                   |  |
|                                  | 8           | 8,4                 | KCS 8-10*  |        |                     | 14                  | 9      | 8                   | 9                   | 24,5   | 5,96           |            |                   |  |
|                                  | 10          | 10,5                | KCS 10-10* |        |                     | 16                  | 9      | 10                  | 11                  | 27     | 6,36           |            |                   |  |
| 16                               | 5           | 5,3                 | KCS 5-16   | 1,5    | 5,5                 | 13                  | 13     | 8,2                 | 8,2                 | 28     | 9,96           | 50         | 8                 | EPZC300, EPZ300,<br>GZ300, HRZ300,<br>PRZ240, GO300,<br>HR300, GU300,<br>GU120, HR100-U,<br>PR240, PR50,<br>R50, PP19                          |
|                                  | 6           | 6,4                 | KCS 6-16*  |        |                     | 12,5                | 10     | 6                   | 7,5                 | 24     | 9,12           |            |                   |  |
|                                  | 8           | 8,4                 | KCS 8-16*  |        |                     | 14,5                | 10     | 8                   | 9                   | 26     | 10,06          |            |                   |  |
|                                  | 10          | 10,5                | KCS 10-16* |        |                     | 17                  | 10     | 10                  | 11                  | 28     | 10,56          |            |                   |  |
| 25                               | 6           | 6,4                 | KCS 6-25*  | 1,5    | 7                   | 14                  | 11     | 6                   | 7,5                 | 27     | 11,74          | 50         | 10                | PP19<br>+ as below   |
|                                  | 8           | 8,4                 | KCS 8-25*  |        |                     | 16                  | 11     | 8                   | 9                   | 28     | 13,06          |            |                   |  |
|                                  | 10          | 10,5                | KCS 10-25* |        |                     | 18                  | 11     | 10                  | 11                  | 31     | 15,56          |            |                   |  |
|                                  | 12          | 13                  | KCS 12-25  |        |                     | 19                  | 15     | 13                  | 14                  | 35     | 15,32          |            |                   |  |
| 35                               | 6           | 6,4                 | KCS 6-35*  | 1,75   | 8,5                 | 17                  | 15     | 6                   | 7,5                 | 31,5   | 18,90          | 20         | 12                | EPZC300,<br>EPZ300, GZ300,<br>HRZ300,<br>PRZ240,<br>GO300, HR300,<br>GU300, GU120,<br>HR100-U,<br>PR240, PR120,<br>PR150, PR50,<br>PP19, A11/6 |
|                                  | 8           | 8,4                 | KCS 8-35*  |        |                     | 17                  | 15     | 8                   | 9                   | 33     | 20,35          |            |                   |  |
|                                  | 10          | 10,5                | KCS 10-35* |        |                     | 19                  | 15     | 10                  | 11                  | 35     | 21,80          |            |                   |  |
|                                  | 12          | 13                  | KCS 12-35  |        |                     | 21                  | 17     | 13                  | 14                  | 38     | 23,15          |            |                   |  |
|                                  | 14          | 15                  | KCS 14-35  |        |                     | 21                  | 17     | 15,5                | 15,5                | 40     | 23,80          |            |                   |  |
| 50                               | 8           | 8,4                 | KCS 8-50*  | 2      | 10                  | 20                  | 17     | 8                   | 10                  | 38,5   | 32,30          | 20         | 14                | EPZC300,<br>EPZ300, GZ300,<br>HRZ300,<br>PRZ240,<br>GO300, HR300,<br>GU300, GU120,<br>HR100-U,<br>PR240, PR120,<br>PR150, PR50,<br>PP19, A11/6 |
|                                  | 10          | 10,5                | KCS 10-50* |        |                     | 20                  | 17     | 10                  | 11                  | 39     | 31,25          |            |                   |  |
|                                  | 12          | 13                  | KCS 12-50* |        |                     | 21                  | 17     | 12                  | 13                  | 40,5   | 31,4           |            |                   |  |
|                                  | 14          | 15                  | KCS 14-50  |        |                     | 23                  | 19     | 15,5                | 15,5                | 43     | 32,70          |            |                   |  |
|                                  | 16          | 17                  | KCS 16-50  |        |                     | 28                  | 19     | 16                  | 17                  | 45     | 35,80          |            |                   |  |

## KCS Tubular terminal

for multi-wire Cu cables

| Cross section [mm <sup>2</sup> ] | For screw M | d <sub>2</sub> [mm] | Symbol      | s [mm] | d <sub>1</sub> [mm] | d <sub>3</sub> [mm] | a [mm] | l <sub>1</sub> [mm] | l <sub>2</sub> [mm] | l [mm] | Weight [g/pce] | Unit [pcs] | Dies discriminant | Crimping tools  |
|----------------------------------|-------------|---------------------|-------------|--------|---------------------|---------------------|--------|---------------------|---------------------|--------|----------------|------------|-------------------|---|
| 70                               | 8           | 8,4                 | KCS 8-70*   | 2,25   | 12                  | 23,5                | 17     | 8                   | 10                  | 40     | 47,55          | 20         | 16                |   |
|                                  | 10          | 10,5                | KCS 10-70*  |        |                     | 23,5                | 17     | 10                  | 11                  | 42     | 41,00          |            |                   |   |
|                                  | 12          | 13                  | KCS 12-70   |        |                     | 23,5                | 13     | 14                  | 46                  | 47,20  |                |            |                   |   |
|                                  | 14          | 15                  | KCS 14-70   |        |                     | 23,5                | 15,5   | 15,5                | 48                  | 49,65  |                |            |                   |   |
|                                  | 16          | 17                  | KCS 16-70   |        |                     | 28                  | 16     | 17                  | 50                  | 49,70  |                |            |                   |   |
| 95                               | 8           | 8,4                 | KCS 8-95    | 2,25   | 13,5                | 26                  | 25     | 10                  | 11                  | 49     | 55,80          | 10         | 18                | EPZC300,<br>EPZ300,<br>GZ300,<br>HRZ300,<br>PRZ240,<br>HRZ300,<br>G0300,<br>HR300,<br>GU300,<br>GU120,<br>HR100-U,<br>PR240,<br>PR120,<br>PR150 |
|                                  | 10          | 10,5                | KCS 10-95*  |        |                     | 26                  | 20     | 10                  | 11                  | 44     | 48,50          |            |                   |   |
|                                  | 12          | 13                  | KCS 12-95*  |        |                     | 26                  | 20     | 12                  | 13                  | 47     | 59,70          |            |                   |   |
|                                  | 14          | 15                  | KCS 14-95   |        |                     | 26                  | 25     | 15,5                | 15,5                | 53     | 59,20          |            |                   |   |
|                                  | 16          | 17                  | KCS 16-95   |        |                     | 28                  | 25     | 16                  | 17                  | 55     | 59,80          |            |                   |   |
|                                  | 20          | 21                  | KCS 20-95   |        |                     | 34                  | 25     | 19                  | 20                  | 57     | 69,80          |            |                   |   |
| 120                              | 8           | 8,4                 | KCS 8-120   | 2,25   | 15,5                | 29                  | 26     | 10                  | 11                  | 51     | 64,70          | 10         | 19                | HR100-U,<br>PR240,<br>PR120,<br>PR150   |
|                                  | 10          | 10,5                | KCS 10-120* |        |                     | 29                  | 23     | 10                  | 11                  | 51     | 68,40          |            |                   |   |
|                                  | 12          | 13                  | KCS 12-120* |        |                     | 29                  | 23     | 12                  | 13                  | 53     | 72,80          |            |                   |   |
|                                  | 14          | 15                  | KCS 14-120  |        |                     | 29                  | 26     | 15,5                | 15,5                | 56     | 72,80          |            |                   |   |
|                                  | 16          | 17                  | KCS 16-120  |        |                     | 29                  | 26     | 16                  | 17                  | 58     | 72,30          |            |                   |   |
|                                  | 20          | 21                  | KCS 20-120  |        |                     | 35                  | 26     | 19                  | 20                  | 61     | 78,40          |            |                   |   |
| 150                              | 10          | 10,5                | KCS 10-150  | 2,25   | 17                  | 31                  | 28     | 12                  | 13                  | 57     | 83,00          | 10         | 20                | EPZC300, EPZ300,<br>GZ300, HRZ300,<br>PRZ240, G0300,<br>HR300, GU300,<br>PR240, PR150   |
|                                  | 12          | 13                  | KCS 12-150  |        |                     | 31                  | 28     | 13                  | 14                  | 58     | 81,60          |            |                   |   |
|                                  | 14          | 15                  | KCS 14-150  |        |                     | 31                  | 30     | 15,5                | 15,5                | 62     | 76,40          |            |                   |   |
|                                  | 16          | 17                  | KCS 16-150  |        |                     | 31                  | 30     | 16                  | 17                  | 62     | 93,50          |            |                   |   |
|                                  | 20          | 21                  | KCS 20-150  |        |                     | 36                  | 30     | 19                  | 20                  | 66     | 96,70          |            |                   |   |
| 185                              | 10          | 10,5                | KCS 10-185  | 2,5    | 19                  | 35                  | 30     | 12                  | 13                  | 62     | 105,00         | 10         | 23                | PR240, PRZ240<br>+ as below   |
|                                  | 12          | 13                  | KCS 12-185  |        |                     | 35                  | 30     | 13                  | 14                  | 63     | 112,00         |            |                   |   |
|                                  | 14          | 15                  | KCS 14-185  |        |                     | 35                  | 30     | 15,5                | 15,5                | 65     | 110,80         |            |                   |   |
|                                  | 16          | 17                  | KCS 16-185  |        |                     | 35                  | 30     | 16                  | 17                  | 67     | 112,00         |            |                   |   |
|                                  | 20          | 21                  | KCS 20-185  |        |                     | 39                  | 30     | 19                  | 20                  | 69     | 118,20         |            |                   |   |
| 240                              | 10          | 10,5                | KCS 10-240  | 2,5    | 21,5                | 39                  | 35     | 12                  | 13                  | 66     | 125,00         | 10         | 25                | EPZC300, EPZ300,<br>GZ300, HRZ300,<br>PRZ240, G0300,<br>HR300, GU300  |
|                                  | 12          | 13                  | KCS 12-240  |        |                     | 39                  | 30     | 12                  | 13                  | 65     | 120,00         |            |                   |   |
|                                  | 14          | 15                  | KCS 14-240  |        |                     | 39                  | 35     | 15,5                | 15,5                | 68     | 123,20         |            |                   |   |
|                                  | 16          | 17                  | KCS 16-240  |        |                     | 39                  | 35     | 16                  | 17                  | 70     | 135,00         |            |                   |   |
|                                  | 20          | 21                  | KCS 20-240  |        |                     | 39                  | 35     | 19                  | 20                  | 73     | 140,60         |            |                   |   |
| 300                              | 12          | 13                  | KCS 12-300  | 3      | 24,5                | 45                  | 45     | 13                  | 14                  | 80     | 195,00         | 10         | 30                | HR300, GU300  |
|                                  | 14          | 15                  | KCS 14-300  |        |                     | 45                  | 45     | 15,5                | 15,5                | 81     | 211,05         |            |                   |   |
|                                  | 16          | 17                  | KCS 16-300  |        |                     | 45                  | 45     | 16                  | 17                  | 83     | 205,00         |            |                   |   |
|                                  | 20          | 21                  | KCS 20-300  |        |                     | 45                  | 45     | 19                  | 20                  | 86     | 217,80         |            |                   |   |
| 400                              | 12          | 13                  | KCS 12-400  | 3,5    | 27                  | 49                  | 44     | 24                  | 24                  | 92     | 335,00         | 5          | 34                | GU625   |
|                                  | 14          | 15                  | KCS 14-400  |        |                     | 49                  | 44     | 24                  | 24                  | 92     | 285,00         |            |                   |   |
|                                  | 16          | 17                  | KCS 16-400  |        |                     | 49                  | 44     | 24                  | 24                  | 92     | 345,83         |            |                   |   |
|                                  | 20          | 21                  | KCS 20-400  |        |                     | 49                  | 44     | 24                  | 24                  | 92     | 281,00         |            |                   |   |

Production on request. Terminal with control hole - symbol KCS-K.