

BPS-B busbar processing station

Coming in 2024.

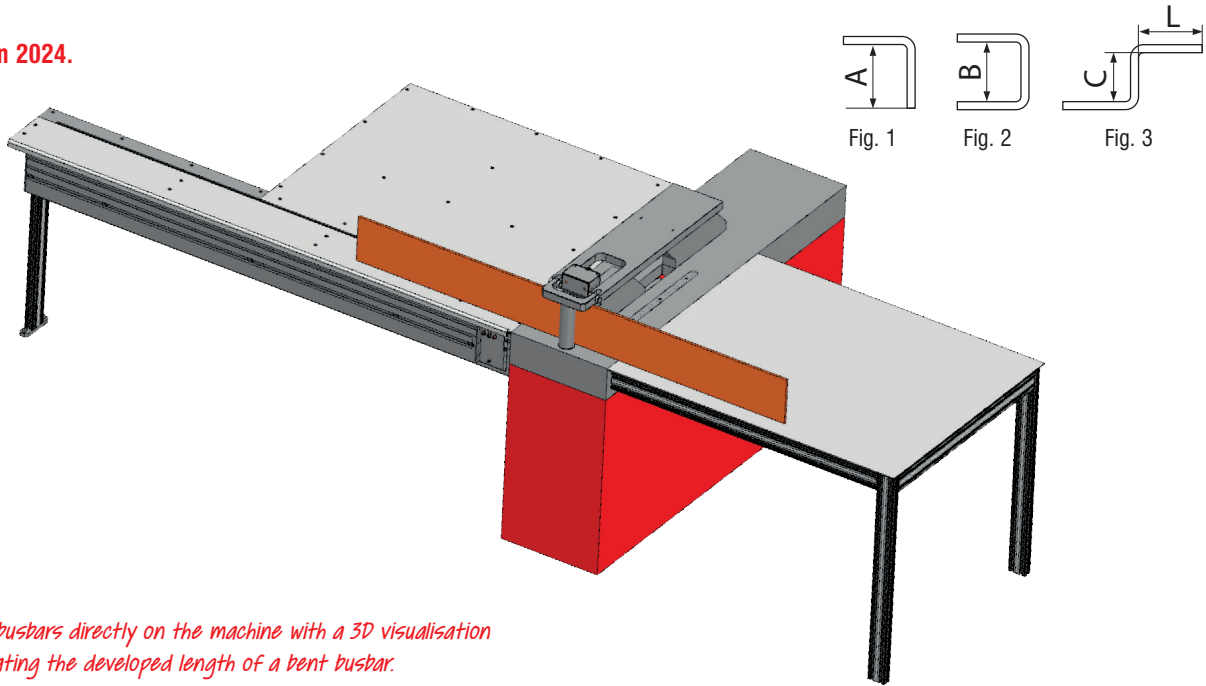

Designing busbars directly on the machine with a 3D visualisation and generating the developed length of a bent busbar.

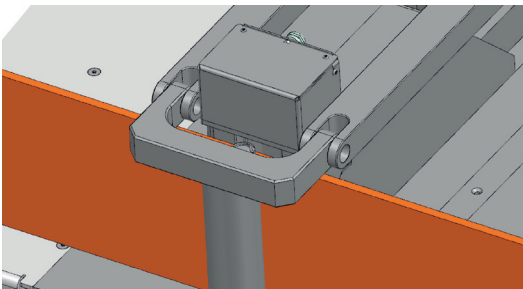

Station for precise bending of Al, Cu, and Al-Cu busbars (in the design phase)

- 1 busbar width 20 ÷ 200 mm
- 2 busbar thickness 3 ÷ 15 mm
- 3 bending angle 5° ÷ 90°

Distinctive features:

- operator support covers designing, technology, and processed material
- application providing possibility to print the designed busbar in 2D and 3D views
- possibility of adaptation to work in the production line
- control system performing CNC functions
- visualisation of the bending process
- Direct work of the machine with the innovative algorithm for designing busbars
- designing busbars directly on the machine with a 3D visualisation and generating the developed length of a bent busbar
- equipped with a 22-inch operator's touchscreen with the multitouch function
- dedicated to high-performance and precise serial production
- busbar feeding ruler accuracy of the position: 0.1 mm
- possibility of bending in an „L” shape for busbars up to 10 mm thick at a distance of 40 mm from the edge (fig. 1)
- possibility of bending in a „C” shape for busbars up to 10 mm thick at a distance of 45 mm from the edge (fig. 2)
- possibility of bending in a „Z” shape for busbars up to 10 mm thick at a distance 40 mm from the edge and between the bends the bends (fig. 3)
- bending angle adjustment to busbar elasticity
- possibility of remote diagnostics
- possibility of saving designs on a network drive
- possibility of using designs developed on desktop software
- possibility of extending the machine with additional machining tools (e.g., custom-made inserts)
- remote software update, including material base
- it facilitates use for people with disabilities
- stable, stationary structure

