

TS Tab

for multi-wire Cu cables

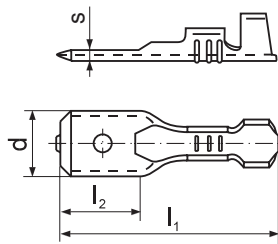

Material: brass
According to DIN 46248

Nominal wire cross section [mm ²]	Cross section [mm ²]	Symbol	s [mm]	l ₁ [mm]	l ₂ [mm]	d [mm]	Cable insulation diameter	Weight [g/pce]	Unit [pcs]	Crimping tools
1	> 0,5 ÷ 1	TS 6,3-1	0,8	20	8,5	6,3	2 ÷ 3,3	0,59	100	PR33, S55, PP8, PP19
2,5	> 1 ÷ 2,5	TS 4,8-2*	0,8	17	7,2	4,8	2,7 ÷ 4,3	0,50	100	
2,5	> 1 ÷ 2,5	TS 6,3-2	0,8	20	8,5	6,3	2,7 ÷ 4,3	0,67	100	
6	> 2,5 ÷ 6	TS 6,3-6	0,8	20	8,5	6,3	3,8 ÷ 5,1	0,76	100	

Standard production – non tinned. When ordering tinned add 'Sn' symbol e.g. TS 6,3-2 Sn.
When ordering nickel plated add 'Ni' symbol e.g. TS 6,3-6 Ni. Made on request.