

## KNP Claw terminal

for multi-wire Cu cables

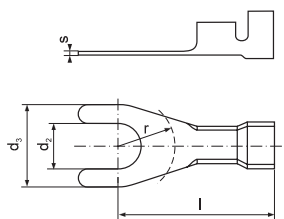
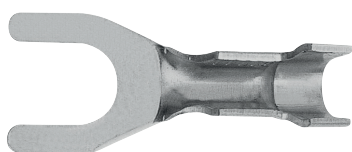
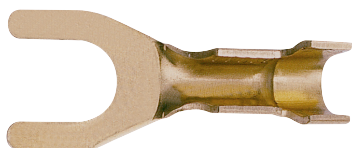

Material: brass  
According to DIN 46225

Cross section [mm <sup>2</sup> ]	For screw M	d <sub>2</sub> [mm]	Symbol	s [mm]	d <sub>3</sub> [mm]	l [mm]	r [mm]	Weight [g/pce]	Unit [pcs]	Crimping tools
0,5 ÷ 1	3	3,2	KNP 3-1	0,6	8	18,3	4,5	0,70	100	
	4	4,3	KNP 4-1		8		6,5			S44-2,
	5	5,3	KNP 5-1		9,5		6,5			
1 ÷ 2,5	4	4,3	KNP 4-2,5	0,6	8	18,3	6,5	0,81	100	
	5	5,3	KNP 5-2,5		9,5		6,5			PP8, PP19
	6	6,5	KNP 6-2,5		12		22			7,5

Standard production – non tinned. When ordering tinned add 'Sn' symbol e.g. KNP 3-1 Sn.