

## KNE Spade terminal

for multi-wire Cu cables

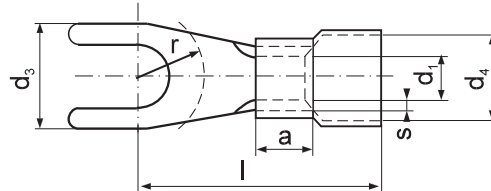
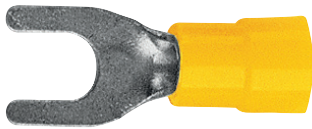

With polyamide insulation  
 Thermal resistance: -40°C to +125°C  
 Material: galvanically tinned copper  
 Tubular part according to DIN 46234

Cross section [mm <sup>2</sup> ]	For screw M	Symbol	s [mm]	d <sub>1</sub> [mm]	d <sub>3</sub> [mm]	d <sub>4</sub> [mm]	l [mm]	a [mm]	r [mm]	Weight [g/pce]	Unit [pcs]	Crimping tools
0,5 ÷ 1	3	KNE 3-1	0,8	1,6	6	4	16	5	4,5	0,64	100	
	4	KNE 4-1-A *			6,8	17	4,5	0,75				
	4	KNE 4-1			8	17	4,5	0,73				
	5	KNE 5-1			10	19	6,5	0,887				
	6	KNE 6-1 *			11	22	7	1,10				
1,5 ÷ 2,5	3	KNE 3-2,5	0,8	2,3	6	5	11	5	4,5	0,77	100	PR33 E11-6 RE6 PP8 PP19
	3,5	KNE 3,5-2,5			6	11	4,5	0,72				
	4	KNE 4-2,5-A *			6,8	17	4,5	0,86				
	4	KNE 4-2,5			8	17	4,5	0,88				
	5	KNE 5-2,5			10	19	6,5	1,07				
	6	KNE 6-2,5			11	21	7	1,21				
	8	KNE 8-2,5			14	22	10	1,45				
4 ÷ 6	4	KNE 4-6	1	3,6	8	7	20	6	4,5	1,68	100	PR33, E11-6 RE6 PP8 PP19
	5	KNE 5-6			10	21	6,5	1,87				
	6	KNE 6-6			11	22	7	2,03				
	8	KNE 8-6			14	25	10	2,49				
10	5	KNE 5-10	1,1	4,5	10	8,4	25	8	6,5	3,00	100	EPZC300, EPZ300, GZ300, HR300, PRZ240, GO300, HRZ300, GU120, HR100-U, PR240, R50, PP19, RA16
	6	KNE 6-10			11	25	7,5	3,30				
	8	KNE 8-10			14	27	10	3,04				

Insulation colours, \* – outside DIN standard

Standard production: the edges of folded tubular part are soldered.  
 VO class insulation on request – symbol e.g. KNE 5-1-VO.