

**KLN-F Tubular Cu connectors**

up to 36kV

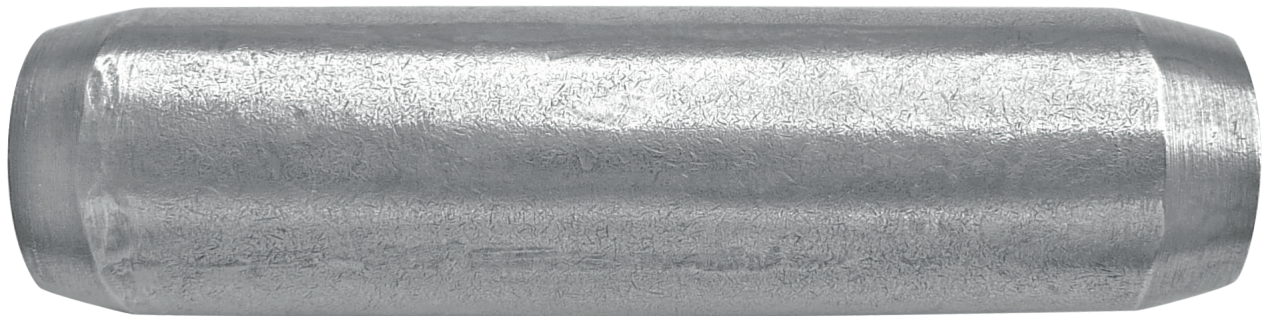

Tubular part dimensions as for KLN  
Range 16 ÷ 625 mm<sup>2</sup>

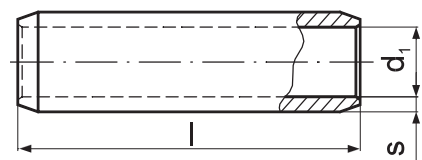

Symbol	l [mm]	s [mm]	d <sub>1</sub> [mm]
KLN-F_16	60	1,5	5,5
KLN-F_25	60	1,5	7
KLN-F_35	60	2,15	8,2
KLN-F_50	65	2,25	10
KLN-F_70	65	2,5	11,5
KLN-F_95	90	2,75	13,5
KLN-F_120	90	2,75	15,5
KLN-F_150	105	3,25	17
KLN-F_185	105	3,25	19
KLN-F_240	125	3,75	21,5
KLN-F_300	125	3,75	24,5
KLN-F_400	160	5,5	27,5
KLN-F_500	175	5,5	31
KLN-F_625	190	4,75	34,5