

## KLA Connector

for multi-wire Cu cables

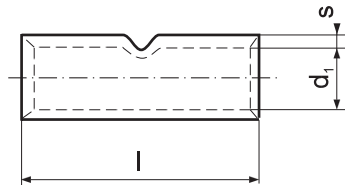
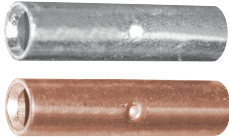

Material: galvanically tinned copper  
Non tinned on request

Cross section [mm <sup>2</sup> ]	Symbol	s [mm]	d <sub>1</sub> [mm]	l [mm]	Weight [g/pce]	Unit [pcs]	Dies discriminant	Crimping tools
0,5 ÷ 1	KLA 1-15	0,8	1,6	15	0,81	100		PR33, A11-6, A22-2,
	KLA 1-20			20	1,06			
1,5 ÷ 2,5	KLA 2,5-15	0,95	2,3	15	1,25	100		RA16, PP8, PP19
	KLA 2,5-20			20	1,76			
4	KLA 4-15	1	3	15	1,64	100		PR33, A11-6, RA16, PP8, PP19
	KLA 4-20			20	2,19			
6	KLA 6-15	1	4	15	2,06	100	6	PR33, PRZ240, A11-6, RA16, PR50, PR240, PP8, PP19
	KLA 6-20			20	2,76			
	KLA 6-30			30	4,21			
10	KLA 10-20	1,2	4,5	20	3,72	50	7	EPZC300, EPZ300, GZ300, HRZ300, PRZ240, GO300, HR300, GU300
	KLA 10-30			30	5,76			
16	KLA 16-25	1,5	5,5	25	7,18	50	8	GU120, HR100-U, PR240, PR120, PR50, R50, PP19, RA16
	KLA 16-30			30	8,64			
	KLA 16-50			50	14,36			
25	KLA 25-29	1,5	7	29	10,20	50	10	PP19, + as below
	KLA 25-35			35	12,22			
	KLA 25-50			50	16,80			
35	KLA 35-32	1,75	8,5	32	15,70	50	12	EPZC300, EPZ300, GZ300, HRZ300, PRZ240, GO300, HR300, GU300
	KLA 35-50			50	25,00			
50	KLA 50-38	2	10	38	25,00	20	14	PR150, PR50, R50
	KLA 50-56			56	37,05			
70	KLA 70-42	2,25	12	42	37,30	20	16	EPZC300, EPZ300, GZ300, HRZ300, PRZ240, GO300, HR300, GU300
	KLA 70-56			56	49,65			
95	KLA 95-48	2,25	13,5	48	48,90	10	17	GU120, HR100-U, PR240, PR120, PR150
	KLA 95-70			70	68,34			
120	KLA 120-52	2,25	15,5	52	58,10	10	19	
	KLA 120-70			70	78,50			
150	KLA 150-56	2,25	17	56	67,70	10	20	PR150, + as below
	KLA 150-80			80	95,70			
185	KLA 185-85	2,5	19	85	125,90	10	23	EPZC300, EPZ300, GZ300, HRZ300, PRZ240, GO300, HR300, GU300, PR240
240	KLA 240-90	2,5	21,5	90	155,00	10	25	
300	KLA 300-100	3	24,5	100	220,00	10	30	EPZC300, EPZ300, GZ300, HRZ300, GO300, HR300, GU300
400	KLA 400-100	3,5	27	100	287,50	10	34	GU625

Production on request. Connectors of other dimensions.