

KCL Tubular terminal

for multi-wire Cu cables

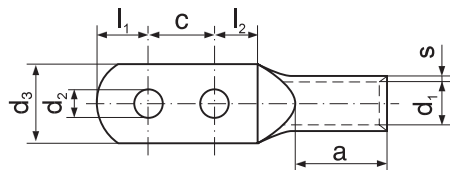
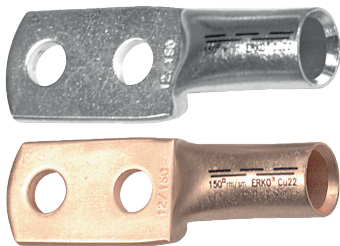

Material: galvanically tinned copper
 Non tinned on request.
 Tubular part dimensions according to DIN 46235

Cross section [mm ²]	For screw M	d ₂ [mm]	Symbol	s [mm]	d ₁ [mm]	d ₃ [mm]	a [mm]	c [mm]	l ₁ [mm]	l ₂ [mm]	Weight [g/pce]	Dies discriminant	Crimping tools
25	6	6,4	KCL 6-25	1,5	7	14	20	20	7,5	8,5	22,53	10	PR50-D, PP19
	8	8,4	KCL 8-25						10	11	21,58		
35	6	6,4	KCL 6-35	2,15	8,2	17	20	20	7,5	8,5	36,90	12	+ as below
	8	8,4	KCL 8-35						10	11	37,86		
50	6	6,4	KCL 6-50	2,25	10	20	28	20	7,5	8,5	53,40	14	EPZC300, EPZ300, GZ300, HRZ300, PRZ240, GO300, HR300, GU300, GU120, HR100-U, PR240, PR120-D, PR150-D, PR50-D
	8	8,4	KCL 8-50						10	11	55,07		
70	8	8,4	KCL 8-70	2,5	11,5	24	28	22	10	11	76,28	16	
	10	10,5	KCL 10-70						12	13	70,30		
95	8	8,4	KCL 8-95	2,75	13,5	28	35	22	10	11	108,83	18	EPZC300, EPZ300, GZ300, HRZ300, PRZ240, GO300, HR300, GU300, GU120, HR100-U, PR240, PR120-D, PR150-D
	10	10,5	KCL 10-95						12	13	113,30		
120	8	8,4	KCL 8-120	2,75	15,5	32	35	30	10	11	132,57	20	
	10	10,5	KCL 10-120						12	13	135,00		
	12	13	KCL 12-120						13	14	135,00		
150	10	10,5	KCL 10-150	3,25	17	34	35	30	12	13	177,47	22	PR150-D
	12	13	KCL 12-150						13	14	179,80		
185	10	10,5	KCL 10-185	3,25	19	37	40	30	12	13	211,55	25	PR240, PRZ240,
	12	13	KCL 12-185						13	14	212,13		
240	10	10,5	KCL 10-240	3,75	21,5	42	40	40	12	13	377,20	28	EPZC300, EPZ300, GZ300, HRZ300, PRZ240, GO300, HR300, GU300
	12	13	KCL 12-240						13	14	314,50		

Production on request. Terminals of dimensions other than in chart.