

IZW Insulators

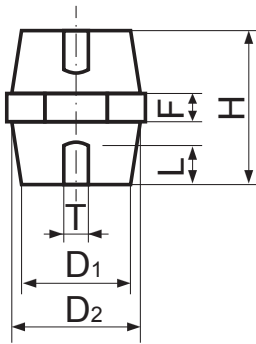

Insulators are used to fix mounting rails in cabinets and low voltage electrical devices. Can be used:

- at high ambient temperatures
- in corrosion exposed environments
- in vibration exposed places

Special features:

- material: thermoset polyester
- UL 94 VO flammability class
- threaded brass sleeve

Symbol	D1	D2	H	F	T	L	Tightening torque [Nm]	Nominal voltage [V]	Number of pieces per unit
IZW_25-M6	18	21	25	7	M6	7	7	400	10 pcs
IZW_30-M6	22	28	30	9	M6	9	7	600	10 pcs
IZW_30-M8	22	28	30	9	M8	7	16	600	10 pcs
IZW_35-M6	25	30	35	9	M6	9	7	600	10 pcs
IZW_35-M8	34	38	35	9	M8	11	16	600	10 pcs
IZW_35-M10	34	38	35	9	M10	11	33	600	10 pcs
IZW_40-M6	20	30	40	8	M6	12	7	1000	10 pcs
IZW_40-M8	35	39	40	8	M8	12	16	1000	10 pcs
IZW_40-M10	35	39	40	8	M10	11	33	1000	10 pcs
IZW_50-M10	33	40	50	11	M10	15	33	1200	10 pcs
IZW_75-M10	52	62	75	13	M10	22	40	2000	10 pcs
IZW_75-M12	52	62	75	13	M12	22	60	2000	10 pcs